



# Place Making

**Outil d'appropriation citoyenne de l'espace public**  
**Générateur d'attractivité**

Jean-Luc CALONGER



Méthodologie de travail

# PLACE MAKING

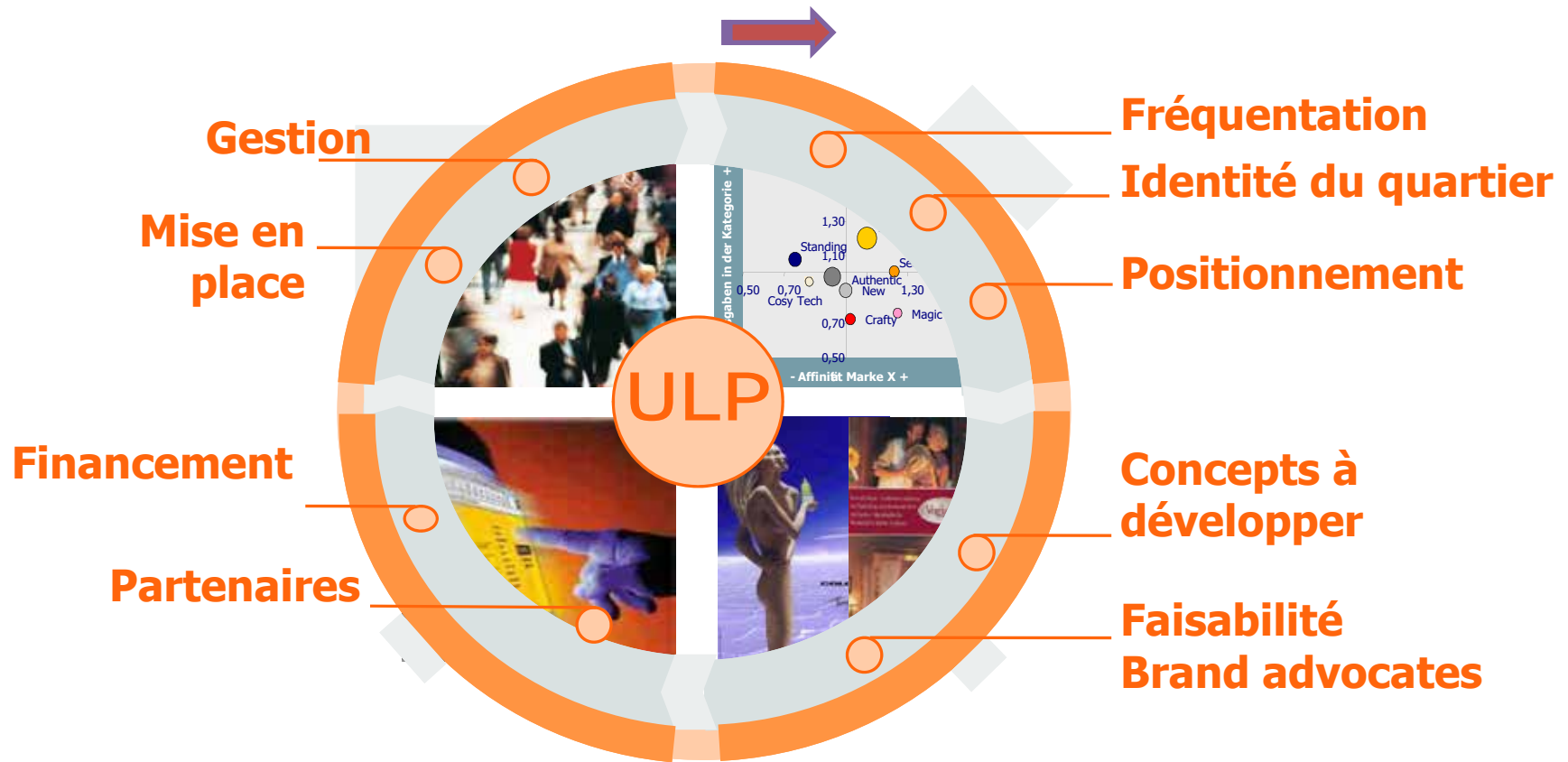



# Place Making Brighton 2012 - 2017





London

Lewes

Zone du projet

Brighton Station  
(train)

The Level  
(park)

North Laine  
(independent retail)

Brighton Pavilion  
(entertainment)

City centre  
(retail)

Kemp Town

Brighton Pier

Hove

Rottingdean











## Project area before changes

















city college

brighton and hove





Ateliers



Propriétaires - Commerçants



Terrain



Pré-propositions



Positionnement

# "COMMON ROOM"

Ann Street/Providence Place Gardens (Lively Cities) Pilot



## PURPOSE

'Common Room' will deliver a series of environmental changes, harnessing the creativity and imagination of the neighbourhood, to effect a genuine and long lasting transformation.

## STRATEGIC

The challenges at the site call for sound urban design to address underlying social and economic issues, as well as concerns regarding environmental quality. Common Room achieves this by delivering adaptability and creating an alignment with the positive changes taking place in the area and sources of future growth, in this way long term and sustainable regeneration may be achieved.

## VISIONARY

We foresee a place of change: at times calm and tranquil, at others alive with movement and activity. Using skills of the art digital infrastructure combined with inspirational design, Common Room will prompt social interaction, play and work related activity, facilitating the cultural uses so important for public spaces to thrive.

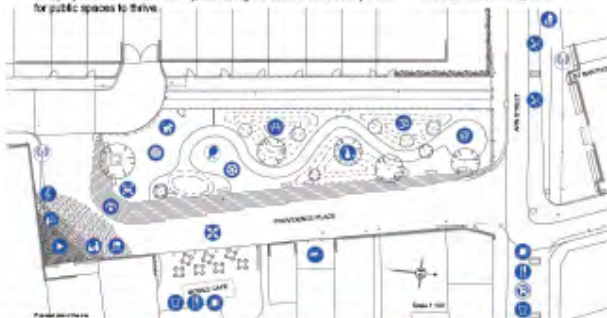

PLAN  
PROJ  
ECTS

livelycities architects

# "COMMON ROOM"

Ann Street/Providence Place Gardens (Lively Cities) Pilot



Providence Place Street View (Left) - Westward Facing View



Providence Place Street View (Right) - Eastward Facing View

## CHANGES

- Installation of servicing systems and removal of fencing
- Providing big connectivity digital infrastructure
- Uplighters to trees in the Gardens
- Reallocating access to Providence Place to all motorised traffic delivery
- Installation of a 'contemporary bandstand'
- Mobile catered food operator in off-street voids
- Temporary licensed occupation of empty commercial units creative industry
- Public seating strategy to deliver informal, movable and fixed seating
- Artificial lawn on Ann Street between Providence Place and London Road
- Legal graffiti wall on the east side of the Gardens
- Pop up garden running the length of Ann Street



livelycities architects

PLAN  
PROJ  
ECTS



















Council officers contribute to design process

# [common ROOM]

Reclaiming Public  
Space in  
Providence  
Place Gardens  
and  
Ann Street

No 1  
June 2013



Welcome to the first edition of the 'Common Room', an occasional newsletter to inform you of progress in improving Ann Street, Providence Place Gardens and the wider area.

## What is the Common Room?

The Common Room was the winning entry to the council's 2012 'Lively Cities' competition for an exciting and innovative two week pilot scheme to transform Ann Street and Providence Place Gardens (the small park opposite St Bart's Church).

The aim of the competition was to provide an attractive open space and wider area that would be used and valued by local people, businesses and people visiting the locality, including London Road shops and services. It was piloted during the first two weeks of October 2012. The two week experiment has provided a great deal of valuable information that will help maximise the success of a permanent transformation of this area.

## INSIDE

What has happened since the end of the pilot project last October?

How can I have my say?

What about street drinking and anti-social behaviour?

# [common ROOM]

Reclaiming  
Public Space in  
Providence  
Place  
Gardens and  
Ann Street

No 2  
June 2014



## Local area improvements Work to start in July

Work will be commencing this summer on the permanent improvements to Ann Street and Providence Place Gardens.

Over the next few months the area will be enhanced in the following ways:

- The removal of the railings and the introduction of terraced steps along the western edge of Providence Place Gardens (the small park opposite St Bartholomew's Church)
- The removal of street parking on Ann Street and Providence Place (adjacent to the park) and its relocation to streets nearby
- A 'shared surface' for pedestrians and vehicles on Ann Street and alongside the park on Providence Place (similar to the approach used in New Road)

*Continued over*



















3 St Peter's St  
Brighton, England  
Street View - Jun 2018



# Un espace réussi ... modulable

□ Points clé  
□ Incorporels





# Place Making

[jean.luc.calonger@amcv.be](mailto:jean.luc.calonger@amcv.be)

